

## INDICE PRODOTTI - PRODUCT CONTENTS

pag. 40-45

SPECIFICHE TECNICHE  
TECHNICAL SPECIFICATIONS

pag. 46-47

PRESCRIZIONI DI UTILIZZO  
USE INSTRUCTIONS

pag. 48-53

ESEMPI E APPLICAZIONI  
EXAMPLES AND APPLICATIONS

pag. 54-57

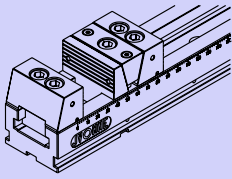

MORSA MULTIPRESA 80  
MULTI-GRIP VICE 80

pag. 58-61

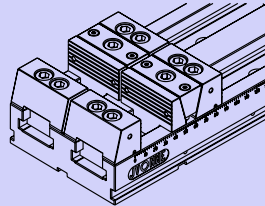

MORSA MULTIPRESA 160  
MULTI-GRIP VICE 160

pag. 62-65

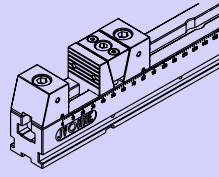

MORSA MULTIPRESA 50  
MULTI-GRIP VICE 50

pag. 66-69

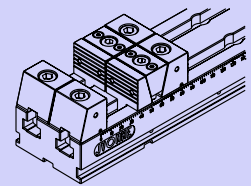

MORSA MULTIPRESA 100  
MULTI-GRIP VICE 100

pag. 70-71

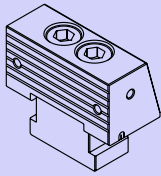

RICAMBI MORSE MULTIPRESA  
80-160  
MULTI-GRIP VICE 80-160  
SPARE PARTS

pag. 72

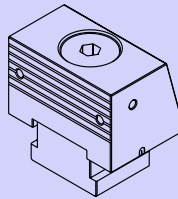

COMPONENTI MORSE  
MULTIPRESA 80-160  
FORTE SERRAGGIO  
MULTI-GRIP VICE 80-160 PARTS  
INTENSE TIGHTENING

pag. 73

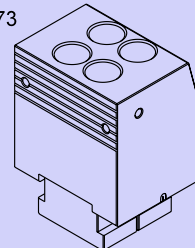

COMPONENTI MORSE  
MULTIPRESA 80-160  
PRESA ALTA  
MULTI-GRIP VICE 80-160 PARTS  
HIGH GRIP

pag. 74-75

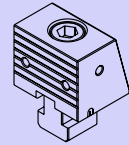

RICAMBI MORSE MULTIPRESA  
50-100  
MULTI-GRIP VICE 50-100  
SPARE PARTS

MORSE MULTIPRESA - MULTI-GRIP VICES

MORSE MULTIPRESA  
MULTI-GRIP VICES

1

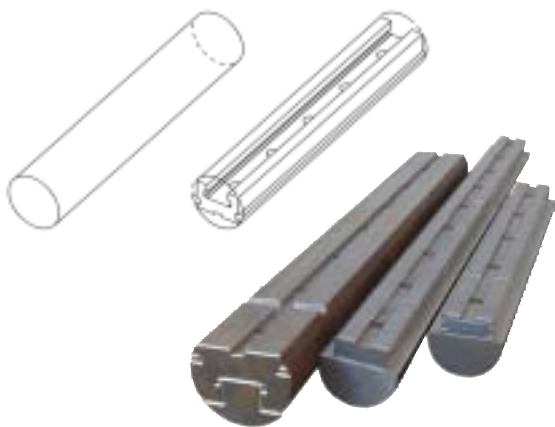

Materiale: 18 NiCrMo5 UNI EN 10083 ricavato da tondo  
Material: 18 NiCrMo5 UNI EN 10083 obtained from rod

2

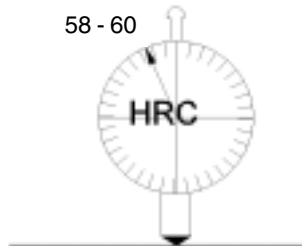

Durezza superficiale dopo cementazione e tempra  
Surface hardness after casehardening and tempering

3

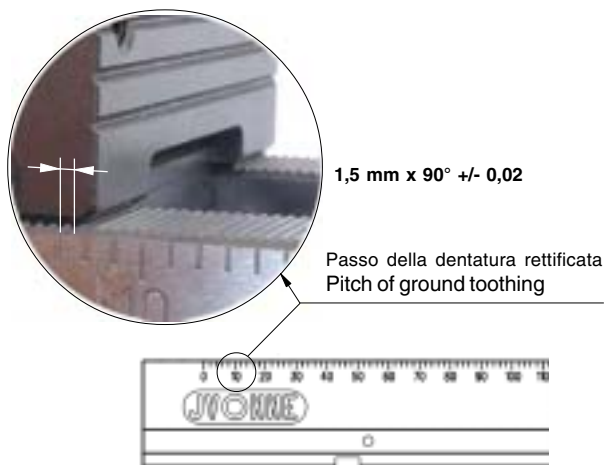

4



Scala graduata incisa su temperato dopo rettificata  
Graduated scale cut on hardened workpiece following grinding

5

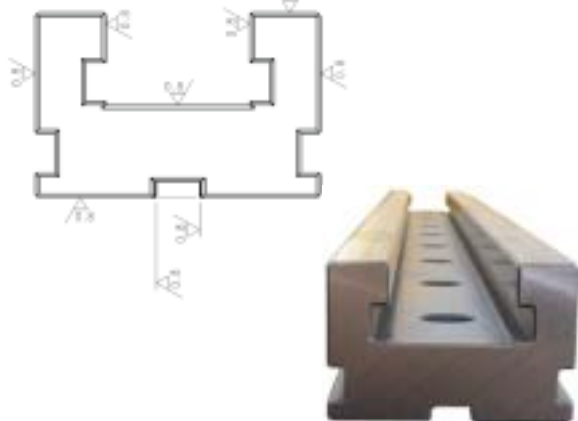

Misure del profilo tutte rettificatae +/- 0,02 mm  
Measurements of section, all ground +/- 0.02mm

6

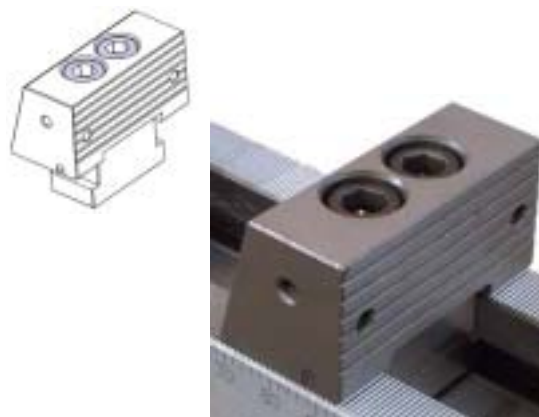

Doppia vite M12 (12.9) per maggior efficacia di reazione  
Double screw M12 (12.9) for improved reaction effectiveness

## MORSE MULTIPRESA - MULTI-GRIP VICES

7 TIPO "A"



TIPO "B"

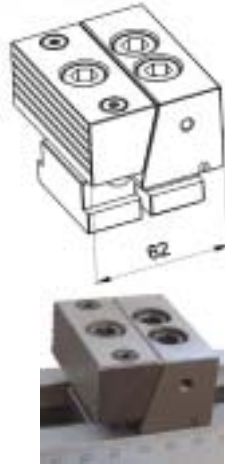

Gruppo di spinta molto compatto e rigido  
Very compact and rigid thrust unit

8

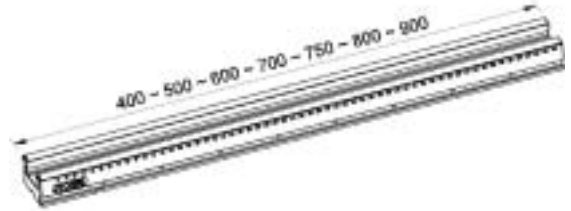

Lunghezza morsa fino a 900 mm  
Vice length up to 900 mm

9

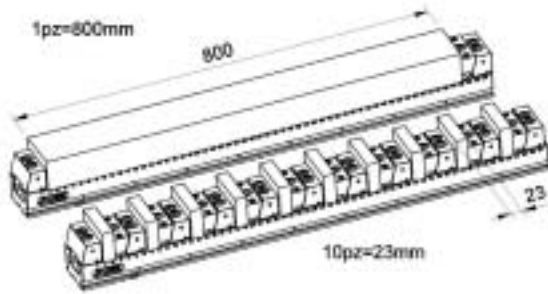

Con la stessa morsa  
With the same vice

10

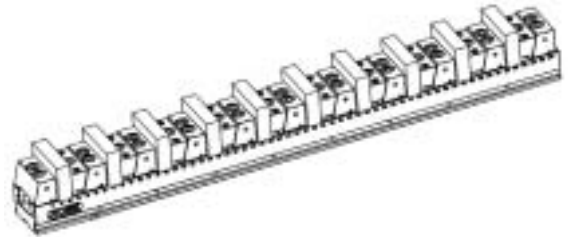

Massimo rapporto ingombro/pezzo  
Maximum overall size/piece ratio

11

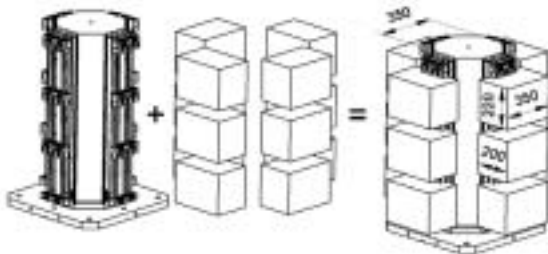

Peso Cubo  
Cube weight  
450 Kg

Peso pz. 950 Kg Acciaio  
Weight of pc: 950 kg Steel  
Peso pz. 550 Kg Alluminio  
Weight of pc: 550 kg aluminium

Massimo peso caricabile  
Maximum loadable weight

12

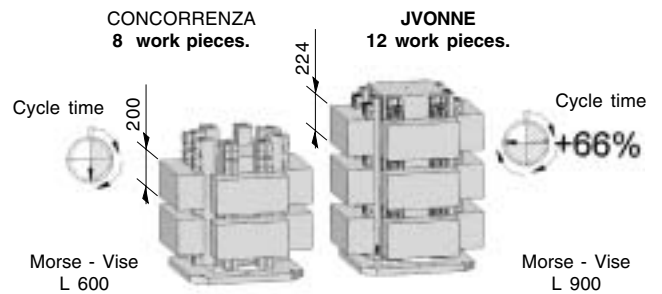

MORSE MULTIPRESA - MULTI-GRIP VICES

MORSE MULTIPRESA  
MULTI-GRIP VICES

13

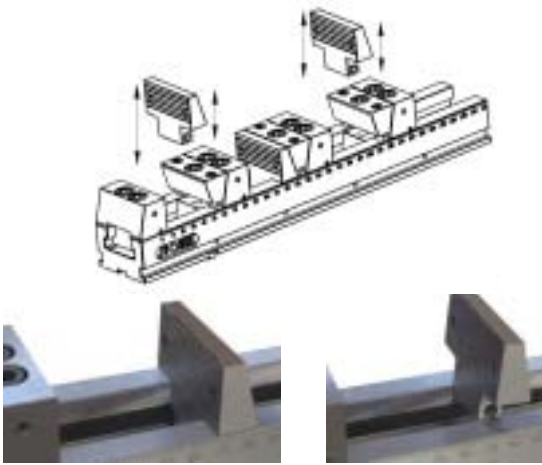

Estrazione rapida della ganascia mobile  
Rapid extraction of movable jaw

14



ISO 9000 - Cert. n° 1194/0

Azienda con sistema di qualità certificato  
Company with certified Quality Assurance system

15

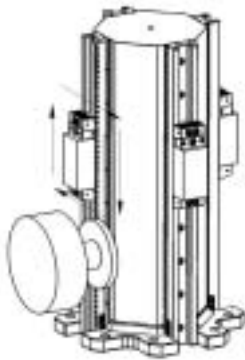

In tutte le morse multipresa JVONNE lo Zero pezzo NON è  
vicolato a inizio morsa  
In all JVONNE vices, the zero position of the workpiece is NOT  
locked at the beginning of the vice

16



**Made in Italy**

Progettate e costruite interamente in Italia  
100% made and designed in Italy



17

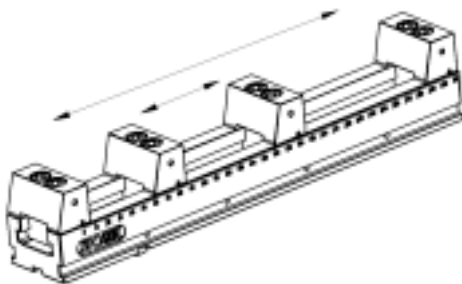

La ganascia fissa di riferimento per lo Zero pezzo si può  
posizionare a piacere sulla dentatura  
The fixed reference jaw for the zero position of the workpiece  
can be positioned wherever you prefer on the toothing

18

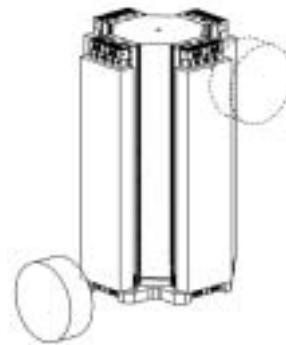

Con il Cubo multipresa ottagonale Plus, possibilità di utilizzare  
al massimo tutta la corsa utile del mandrino  
With the orthogonal multi-grip cube PLUS, you can fully exploit  
the whole useful stroke of the spindle.

**MORSE MULTIPRESA - MULTI-GRIP VICES**

19

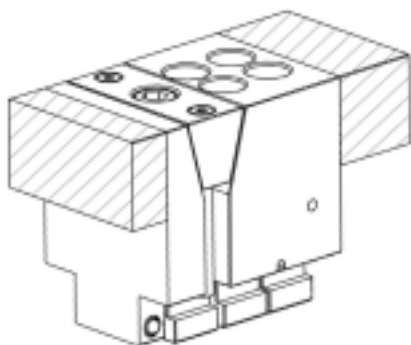

Personalizzazione della presa pezzo con ganasce lavorabili o temperate  
The workpiece gripper can be customised with machinable or hardened jaws

20



Studio soluzioni personalizzate con Work Station 3D CATIA  
Personal solutions with Work Station 3D CATIA

21

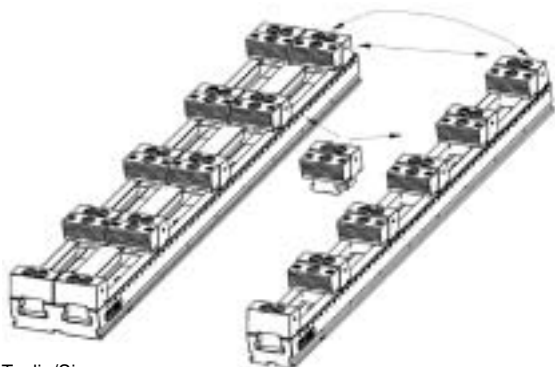

Taglia/Size  
160

Taglia/Size  
80

Intercambiabilità di tutti i componenti  
All components are interchangeable

22

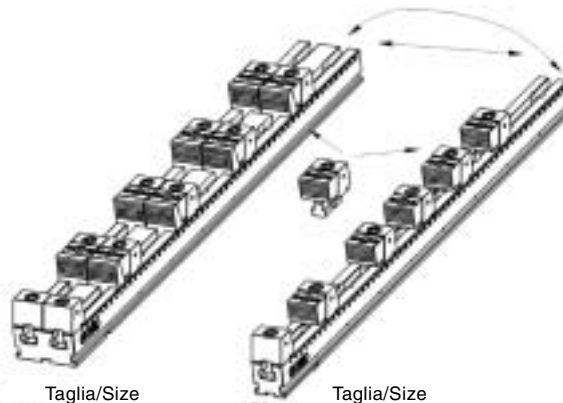

Taglia/Size  
100

Taglia/Size  
50

Intercambiabilità di tutti i componenti  
All components are interchangeable

23

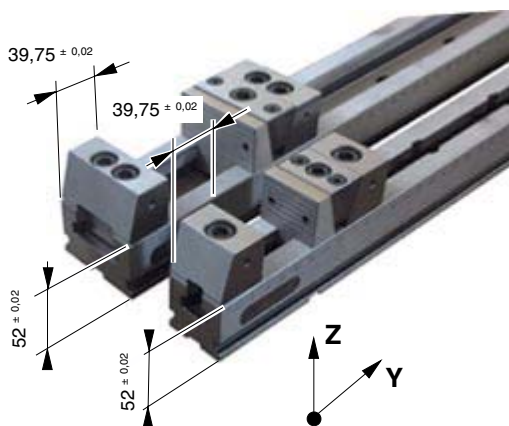

Stesso "0" pezzo in Z e Y per taglie 50-80-100-160  
Same "0" position of workpiece in Z and Y for size 50-80-100-160

24

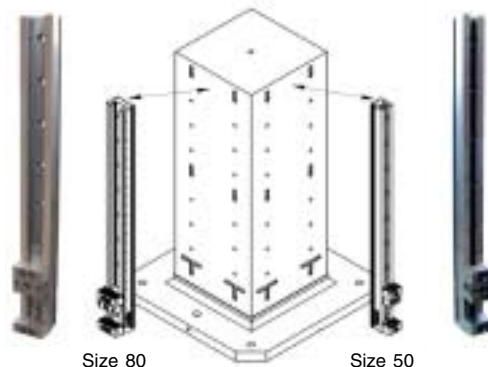

Size 80

Size 50

Intercambiabilità delle sedi per le taglie 50 - 80 - 100 - 160  
The seats are interchangeable for sizes 50 - 80 - 100 - 160



SCHEMA DI FUNZIONAMENTO

OPERATING LAYOUT

TIPO "A"

(traslante) (sliding)

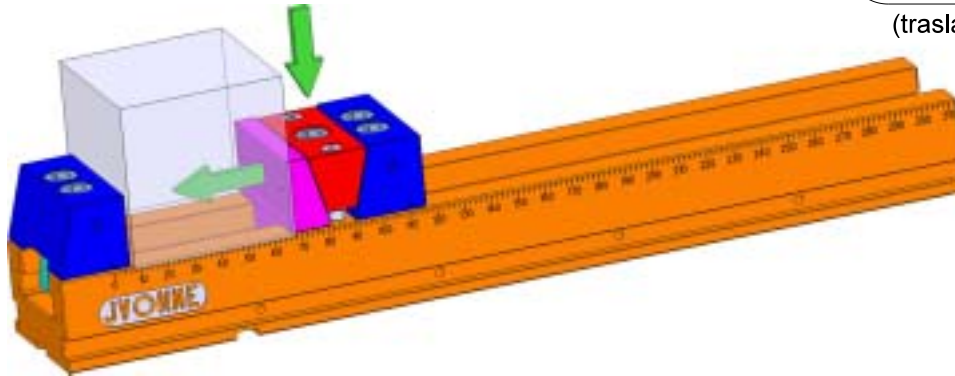

TIPO "B"

(discendente) (descending)

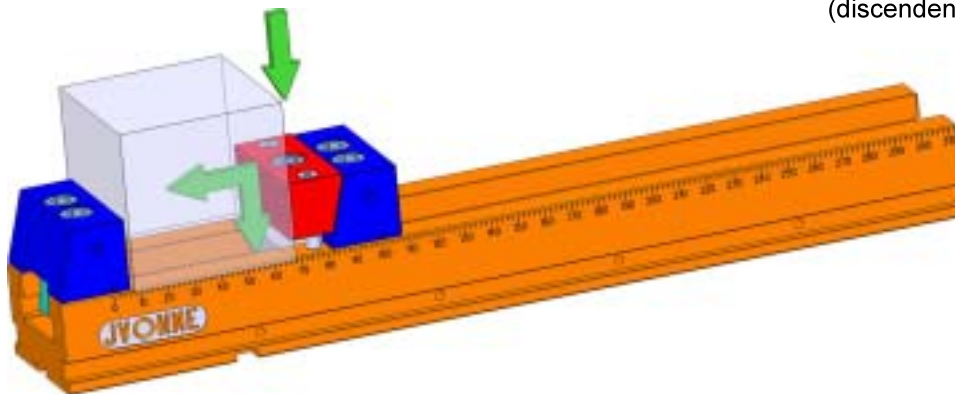

TIPO "C"

(2x1)  
(traslante) (sliding)

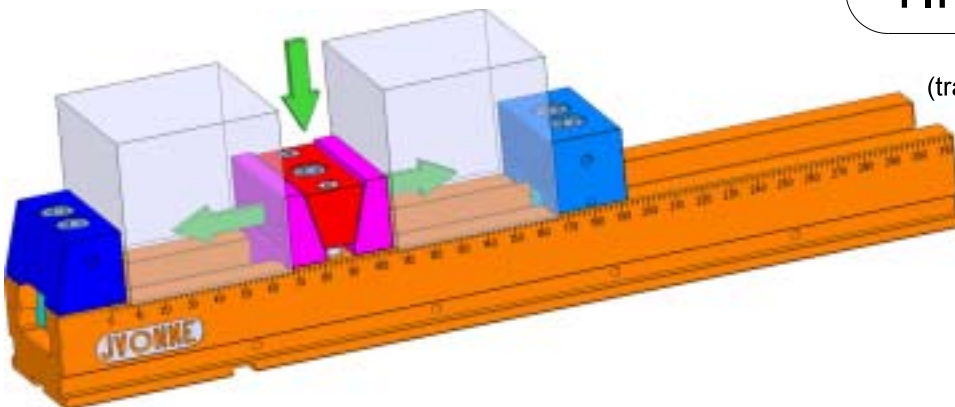

MORSE MULTIPRESA

MULTI-GRIP VICES

Corse disponibili

Available travel

TIPO "A"

(traslante) (sliding)

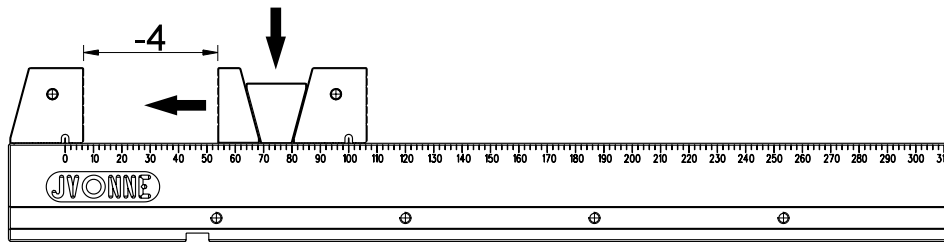
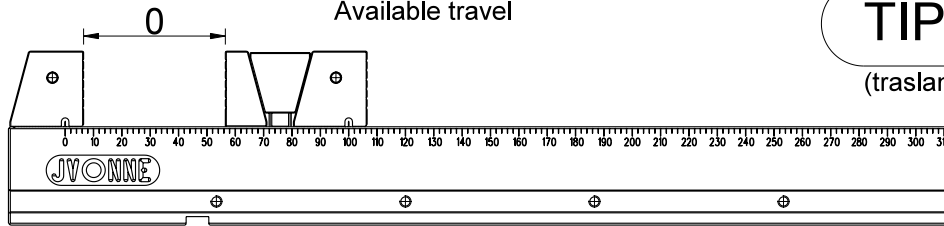

TIPO "B"

(discendente) (descending)

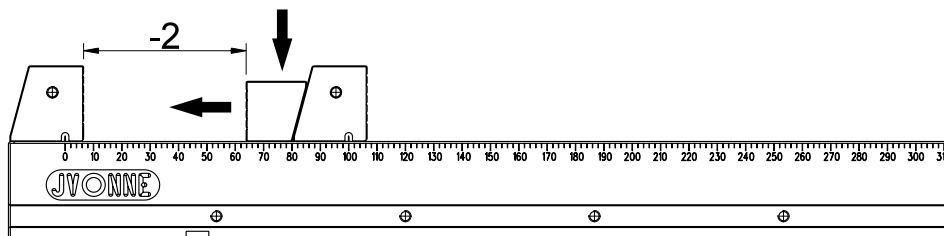
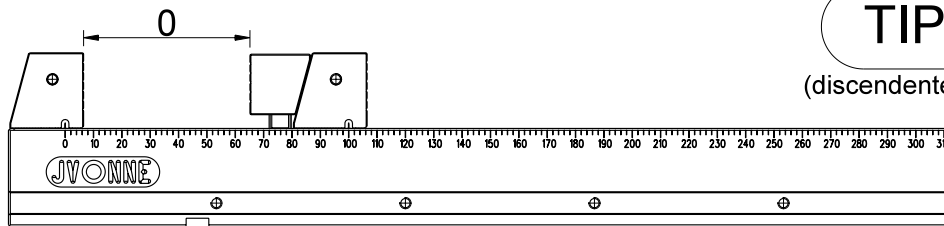

TIPO "C"

(2x1)  
(traslante) (sliding)

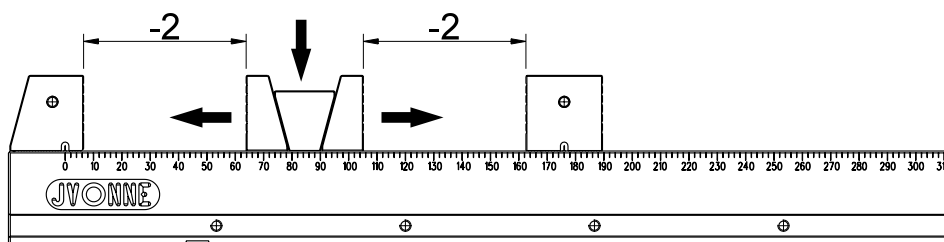
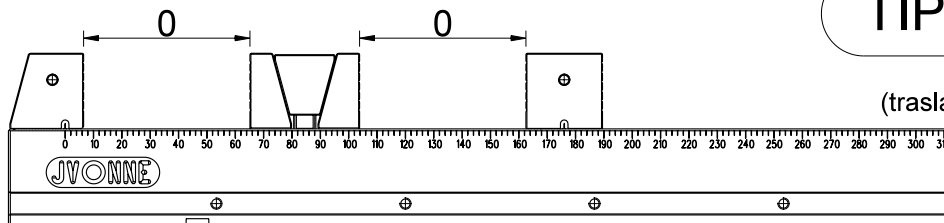

MORSE MULTIPRESA JVONNE

MULTI-GRIP VICE JVONNE

MORSE MULTIPRESA  
MULTI-GRIP VICES

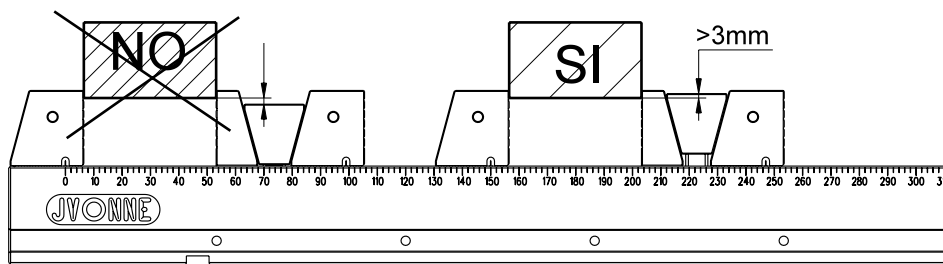
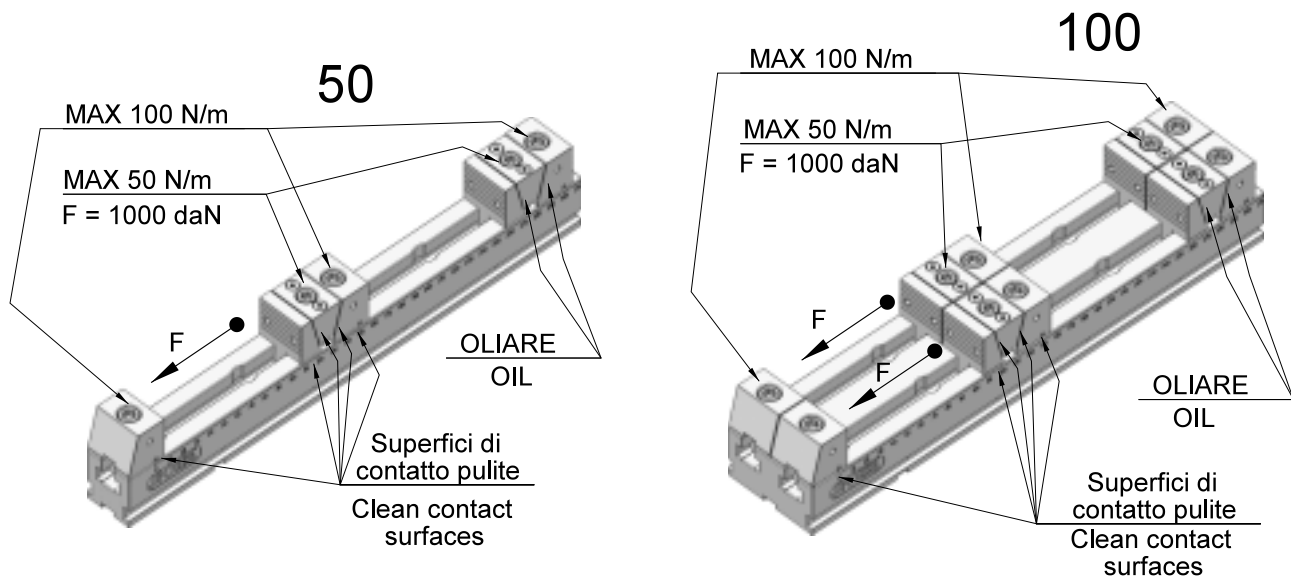

Prescrizioni valide per tutti i tipi di presa pezzo (A,B,C,D,E,F,G,BG, Forte serraggio).

Al fine di ottenere un corretto utilizzo per il serraggio dei pezzi si raccomandano le seguenti modalità:

- pulire con cura le parti zigrinate con soffiaggio di aria compressa;
- assicurare una buona pulizia delle superfici inclinate con una sottile velatura d'olio a bassa densità (diminuisce la perdita di forza dovuta ad attrito);
- chiudere le viti della ganasce fissa con max coppia come indicato;
- chiudere la vite del cuneo di serraggio con max coppia come indicato.

Instructions for all types of piece grips (A,B,C,D,E,F,G,BG, Intense tightening).

Follow the instructions below to ensure the correct tightening of the workpieces:

- carefully clean all knurled parts with compressed air;
- make sure that the sloping surfaces are clean with a thin layer of low density oil (reduces the loss of force due to friction);
- secure the screw of the fixed jaw with a maximum torque as indicated;
- secure the screw of the tightening wedge with a maximum torque as indicated.



MORSE MULTIPRESA JVONNE

MULTI-GRIP VICE JVONNE

MORSE MULTIPRESA  
MULTI-GRIP VICES

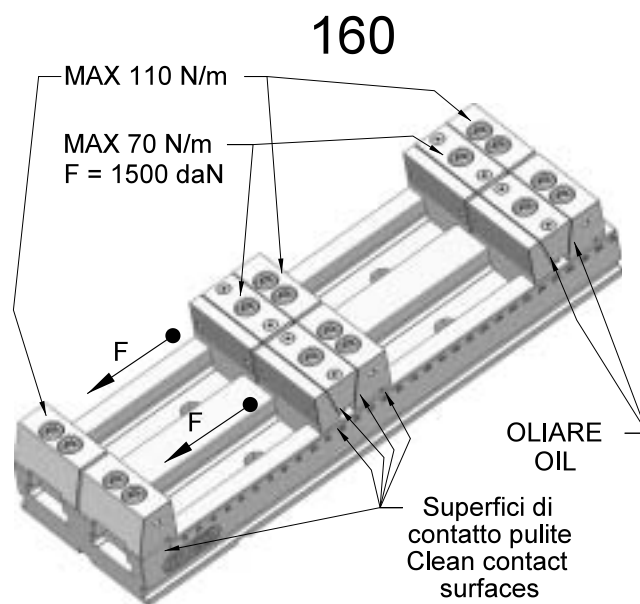
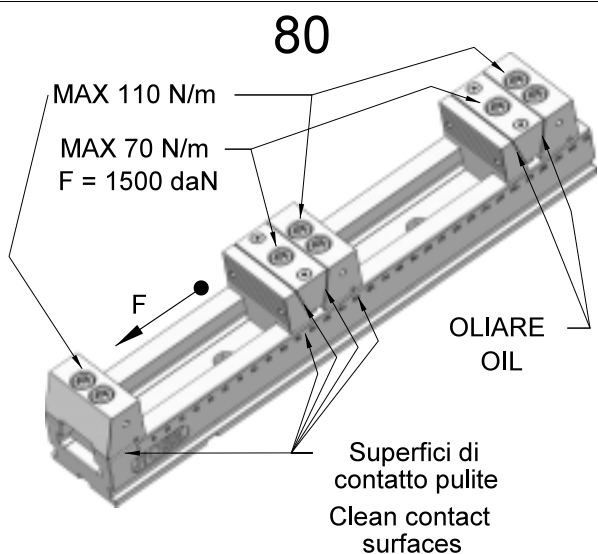

80 Forte Serraggio

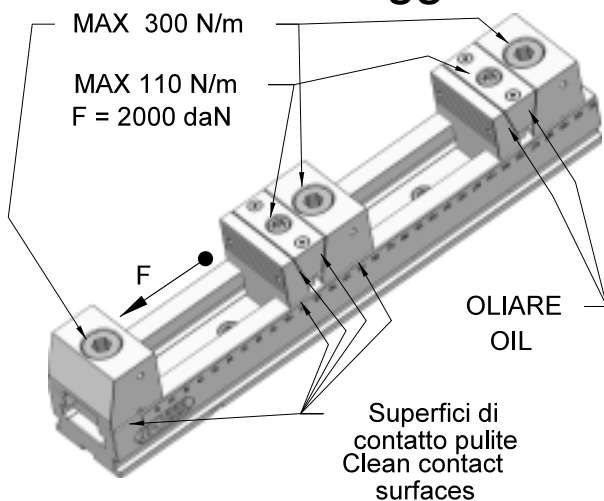

80 Presa Alta

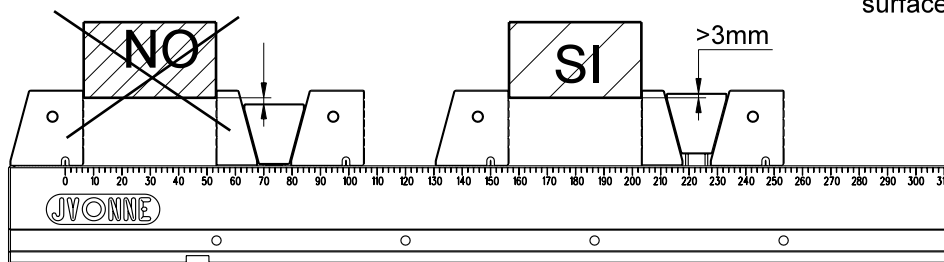
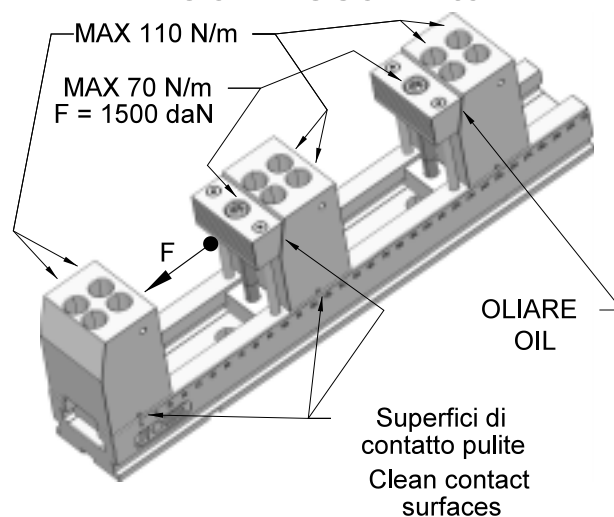

Prescrizioni valide per tutti i tipi di presa pezzo (A,B,C,D,E,F,G,BG, Forte serraggio).

Al fine di ottenere un corretto utilizzo per il serraggio dei pezzi si raccomandano le seguenti modalità:

- pulire con cura le parti zigrinate con soffiaggio di aria compressa;
- assicurare una buona pulizia delle superfici inclinate con una sottile velatura d'olio a bassa densità (diminuisce la perdita di forza dovuta ad attrito).
- chiudere le viti della ganasce fissa con max coppia come indicato;
- chiudere la vite del cuneo di serraggio con max coppia come indicato.

Instructions for all types of piece grips (A,B,C,D,E,F,G,BG, Intense tightening).

Follow the instructions below to ensure the correct tightening of the workpieces:

- carefully clean all knurled parts with compressed air;
- make sure that the sloping surfaces are clean with a thin layer of low density oil (reduces the loss of force due to friction)
- secure the screw of the fixed jaw with a maximum torque as indicated;
- secure the screw of the tightening wedge with a maximum torque as indicated.

MORSE MULTIPRESA

MULTI-GRIP VICES

Esempi di presa pezzo

Workpiece grip example

Tipo A

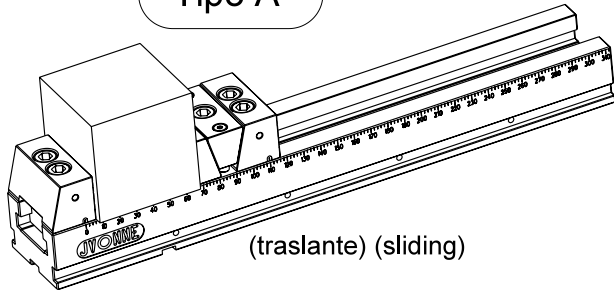

(traslante) (sliding)

Tipo B

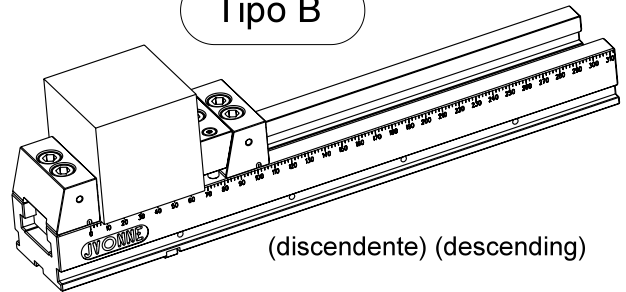

(discendente) (descending)

Tipo C

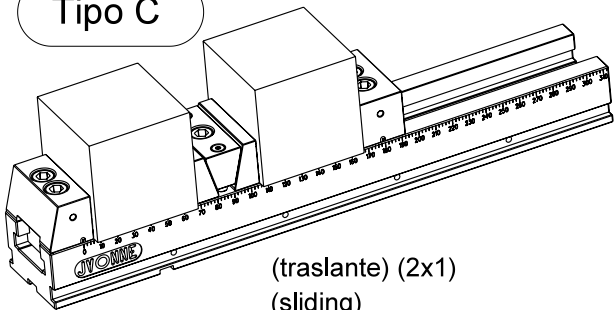

(traslante) (2x1)  
(sliding)

Tipo D

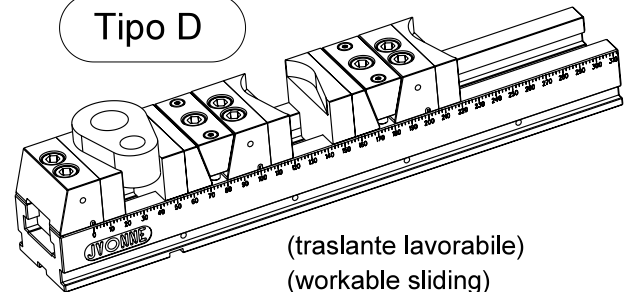

(traslante lavorabile)  
(workable sliding)

Tipo E

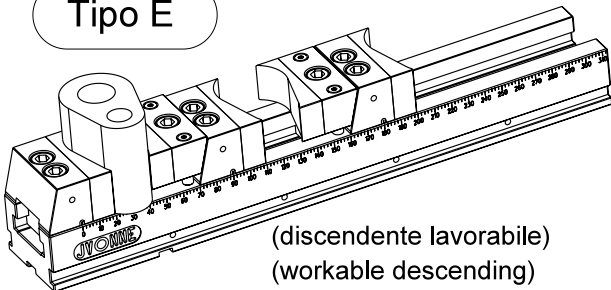

(discendente lavorabile)  
(workable descending)

Tipo F

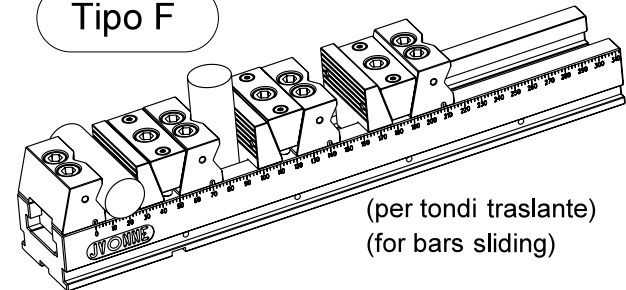

(per tondi traslante)  
(for bars sliding)

Tipo BG

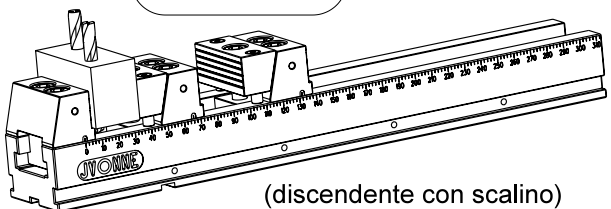

(discendente con scalino)  
(descending with step)

Tipo G

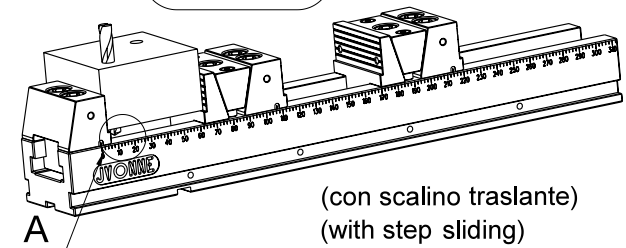

(con scalino traslante)  
(with step sliding)

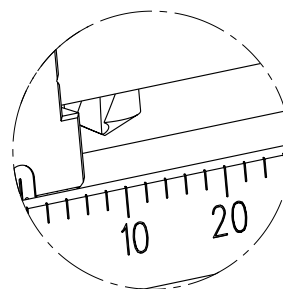
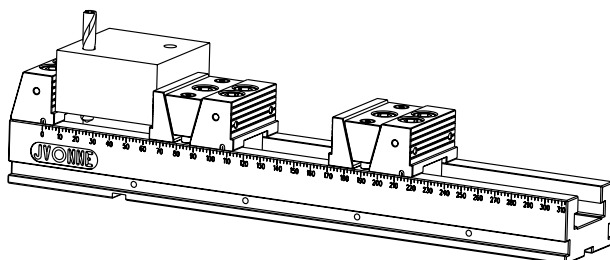

Dettaglio A  
Scala: 1:1

MORSE MULTIPRESA  
MULTI-GRIP VICES

Esempi di presa pezzo

Workpiece grip example

Tipo AW

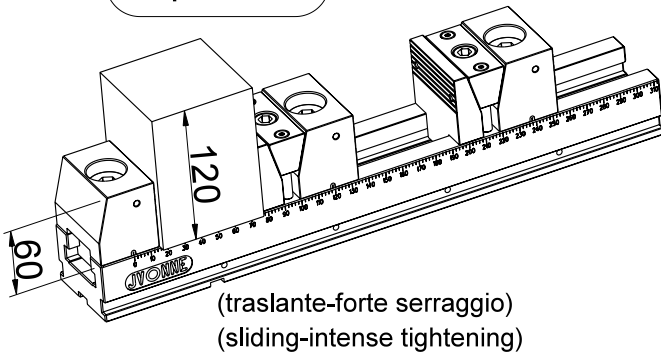

Tipo BX

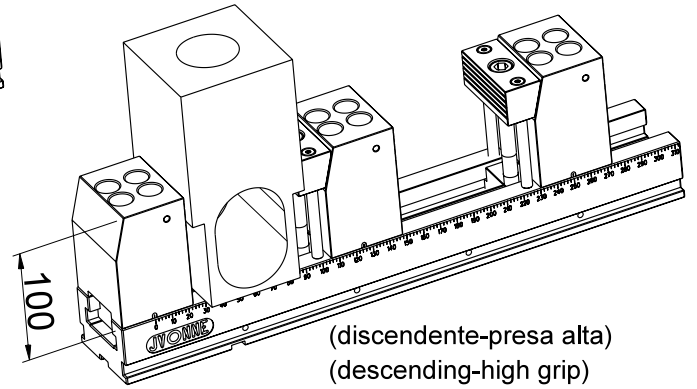

Tipo BW

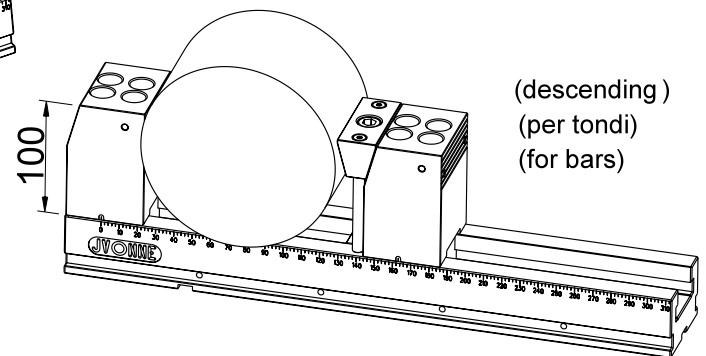
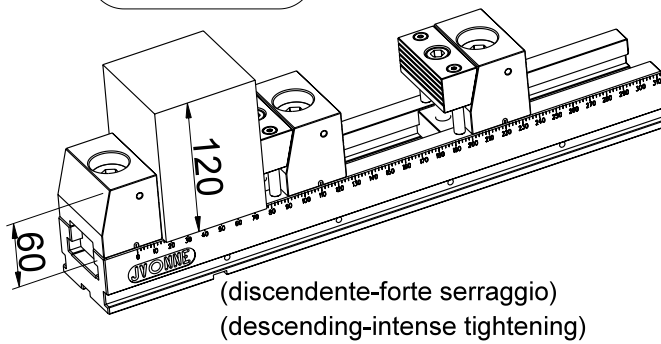

Tipo CW

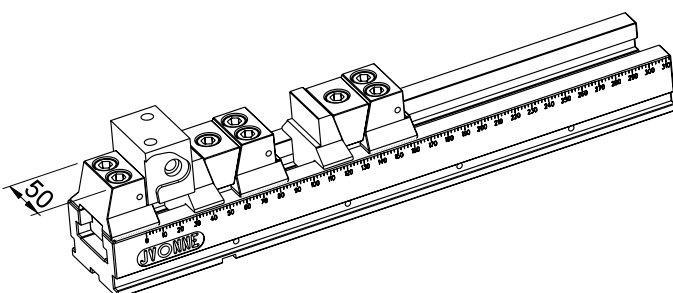
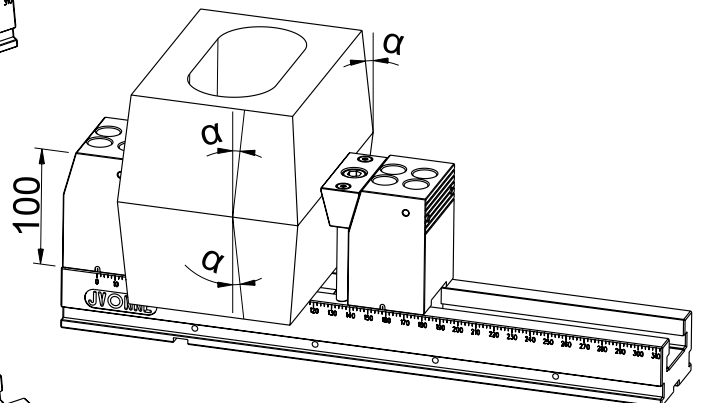
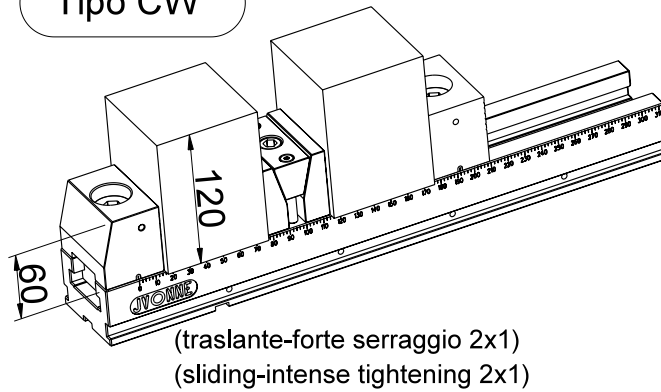

MORSE MULTIPRESA

MULTI-GRIP VICES

Confronto con concorrenza

Comparison with competitors

Confronto a parità di lunghezza morsa e a parità di lunghezza di pezzi

Comparison with equal vice length and equal length of workpieces

ALTRO COSTRUTTORE  
OTHER MANUFACTURER

Concorrenza  
Morsa L700  
Monopresa  
1 pezzo  
L 70mm  
Competitor  
Vice L700  
Single-grip  
1 workpiece  
L 70 mm

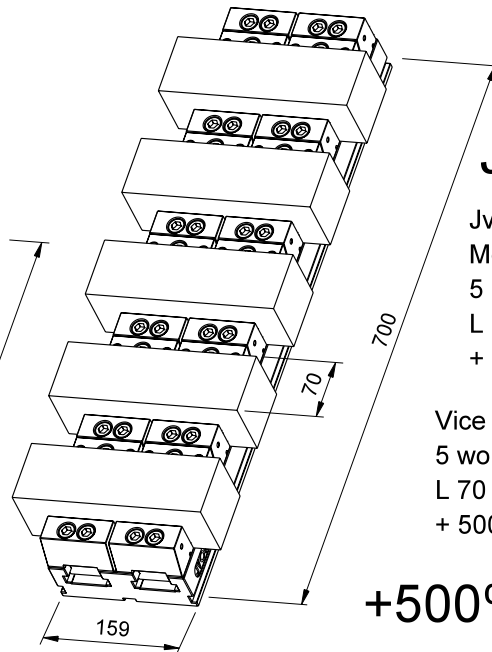
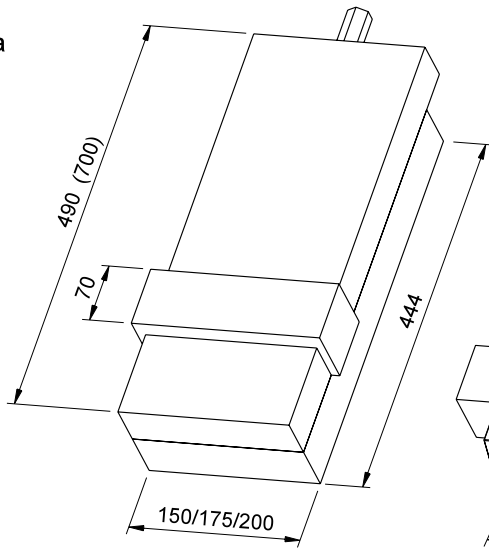

JVONNE

Jvonne  
Morsa L700  
5 pezzi  
L 70  
+ 500% di pezzi

Vice L700  
5 workpieces  
L 70  
+ 500% of workpieces

+500%

Confronto a parità di lunghezza pezzo

Comparison with equal length workpiece

ALTRO COSTRUTTORE  
OTHER MANUFACTURER

Concorrenza  
Morsa L700  
Monopresa  
1 pezzo  
L 200mm  
(max apertura)  
Competitor  
Vice L700  
Single-grip  
1 workpiece  
L 200 mm  
(max opening)

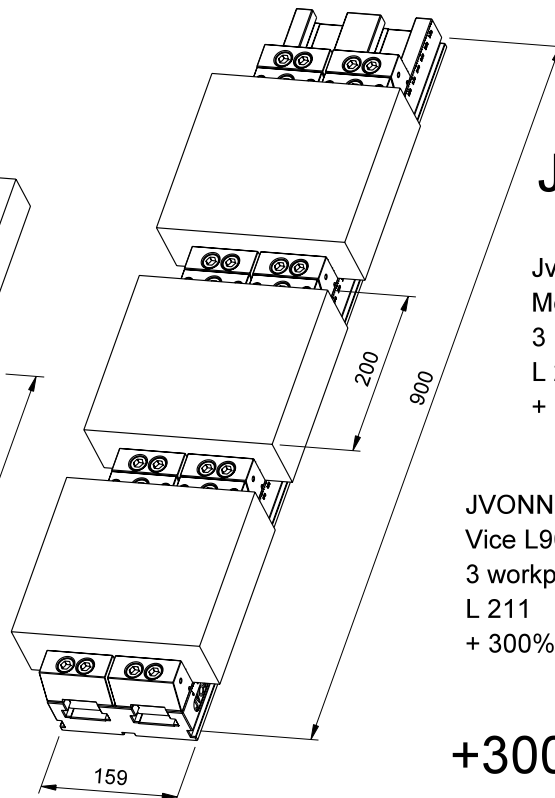
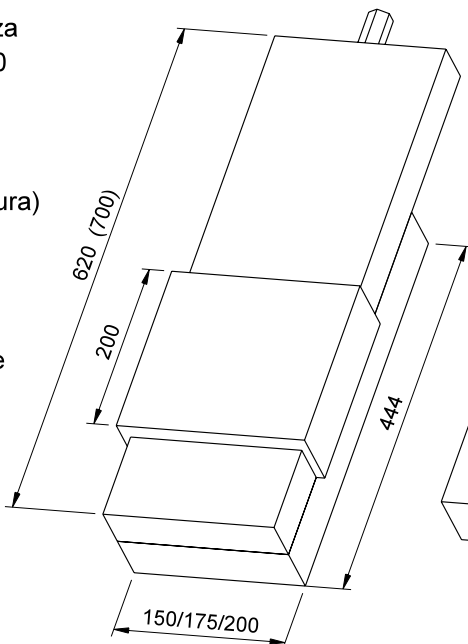

JVONNE

Jvonne  
Morsa L900  
3 pezzi  
L 211  
+ 300% di pezzi

JVONNE  
Vice L900  
3 workpieces  
L 211  
+ 300% of workpieces

+300%

MORSE MULTIPRESA  
MULTI-GRIP VICES

### Confronto con concorrenza

Comparison with competitors

#### Confronto a parità di lunghezza morsa e a parità di n° di pezzi

Comparison with vices of equal length and equal number of workpieces

**ALTRO  
COSTRUTTORE**  
OTHER MANUFACTURER

Concorrenza  
Morsa L700  
7 pezzi  
L 17mm

Competitor  
Vice L700  
7 workpieces  
L 17mm

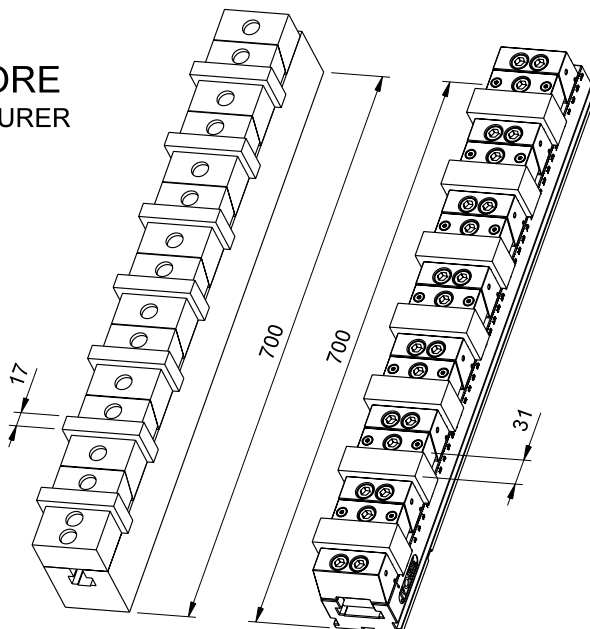

**JVONNE**

Jvonne  
Morsa L700  
7 pezzi  
L 31  
+ 82% di spessore

JVONNE  
Vice L700  
7 workpieces  
L 31  
+ 82% of thickness

**+82%**

#### Confronto a parità di lunghezza pezzo

Comparison with equal length workpiece

**ALTRO  
COSTRUTTORE**  
OTHER MANUFACTURER

Concorrenza  
Morsa L700  
2 pezzi  
L 150mm

Competitor  
Vice L700  
2 workpieces  
L 150 mm

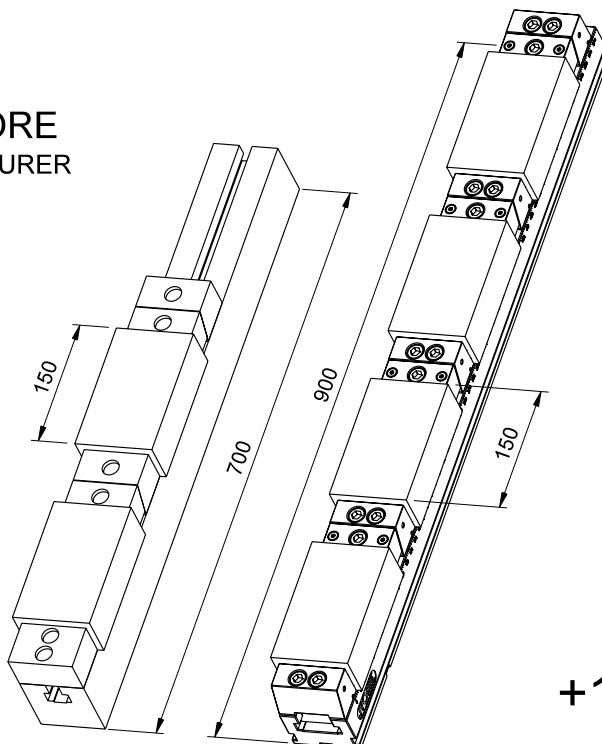

**JVONNE**

Jvonne  
Morsa L900  
4 pezzi  
L 152  
+ 100% di pezzi

JVONNE  
Vice L900  
4 workpieces  
L 152  
+ 100% of workpieces

**+100%**



MORSE MULTIPRESA

MULTI-GRIP VICES

La nuova linea di Morse Multipresa JVONNE permette di CREARE Cubi Multipresa con

**MISURE MAI VISTE PRIMA.**

MORSE MULTIPRESA  
MULTI-GRIP VICES

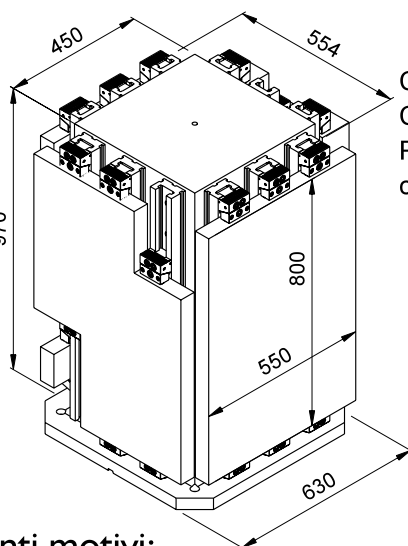
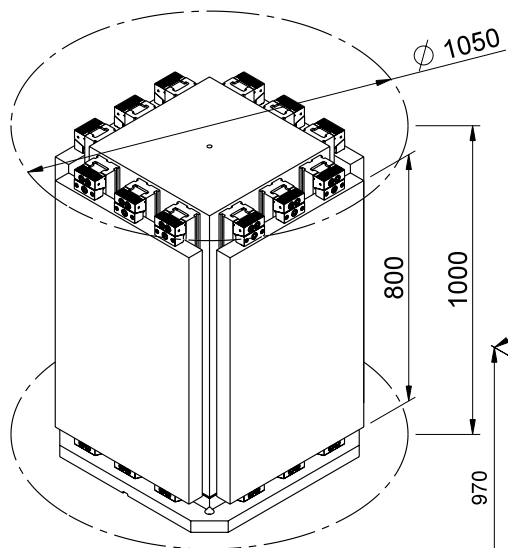

Cod. : J 02 633 S 80 B  
Cubo Quadro Multipresa  
Pallet 630x630 H970  
completo di 12 morse J 80 900 B

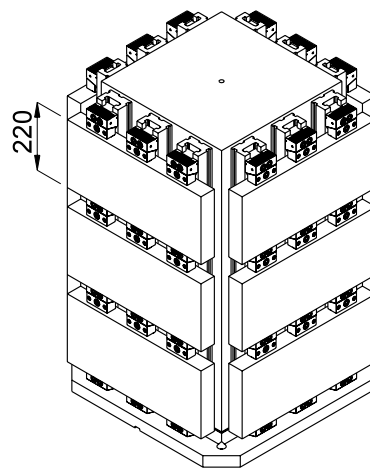

Misure eccezionali per i seguenti motivi:

- 1 - gruppo di spinta molto compatto e rigido
  - 2 - lunghezza morsa fino a 900mm per presa pezzo fino a 800 mm
- PESO CUBO CONTENUTO**

Ecco esplicitati alcuni esempi

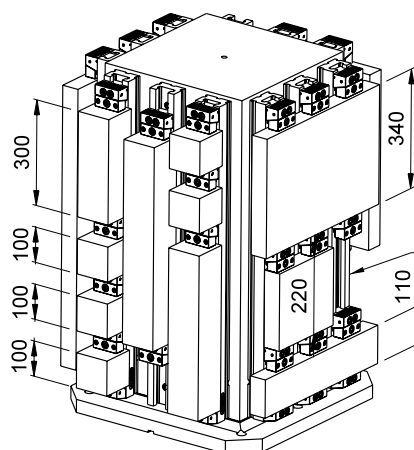
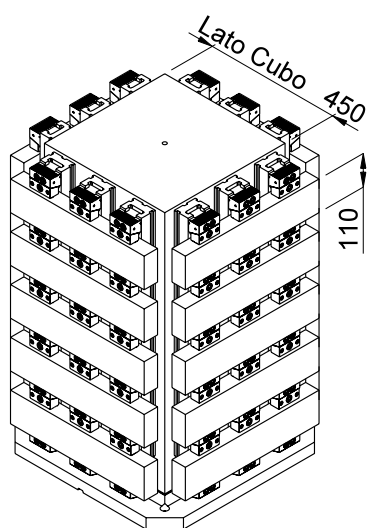

Morsa J 80 900 B  
L = 900

MORSE MULTIPRESA

MULTI-GRIP VICES

