

# KINTEK®

- KINTEK **FAST-IN**  HOLDERS RANGE  
FOR DRIVEN TOOLS **ER25/ER32**
- KINTEK **FAST-IN**  PROGRAMMA PORTAUTENSILI  
PER MOTORIZZATI USCITA **ER25/ER32**
- KINTEK **FAST-IN**  HALTER FÜR  
**ER25/ER32** ANGETRIEBENE
- KINTEK **FAST-IN**  GAMA DE PORTAHERRAMIENTAS  
**ER25/ER32** PARA MOTORIZADAS
- KINTEK **FAST-IN**  GAMME DE PORTE-OUTILS  
POUR MOTORISÉS **ER25/ER32**
- KINTEK **FAST-IN**  ДИАПАЗОН ОПРАВОК ДЛЯ  
ПРИВОДНЫХ ГОЛОВОК **ER25/ER32**
- KINTEK **FAST-IN**  用于动力刀座**ER25/ER32**的刀柄范围



# TOOLHOLDERS WITH SHANK ER25-ER32 - SHORT-LONG

Short

Long

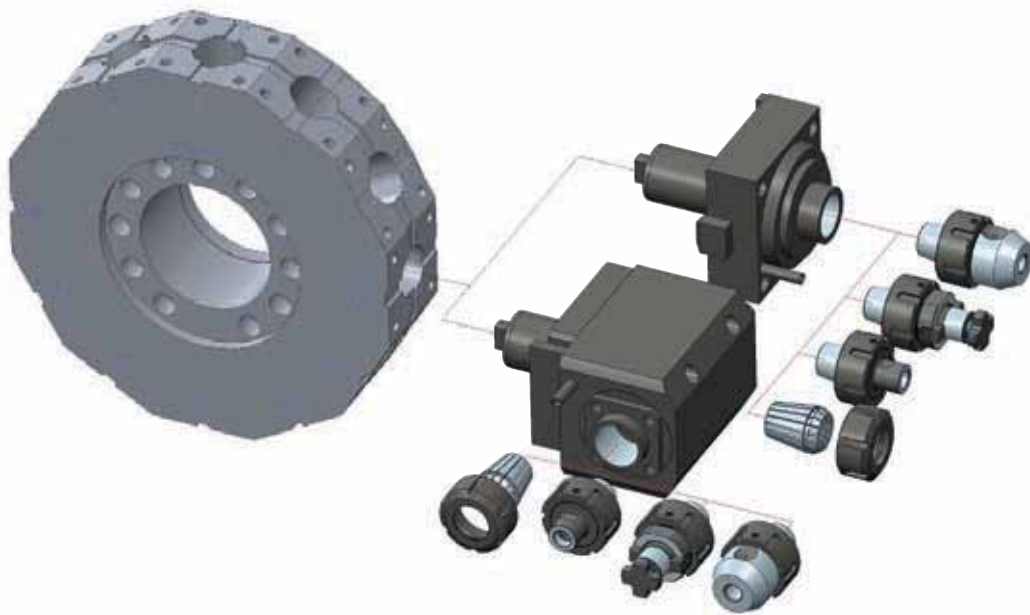
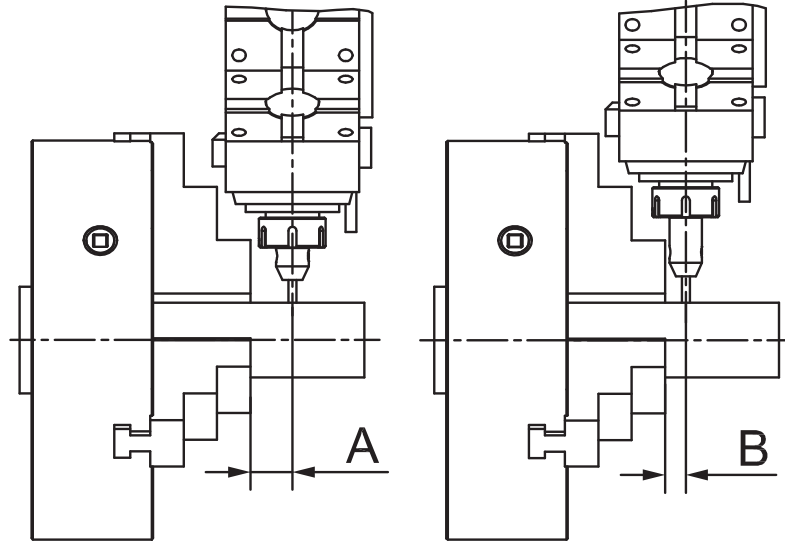

MILLING CUTTER ARBORS FOR SCREW-ON TYPE MILLING CUTTERS

SPANFUTTER FÜR EINSCHRAUBFRÄSER  
CONOS PORTAFRESAS CON EXTREMO ROSCADO  
ОПРАВКИ ДЛЯ ФРЕЗЕРНЫХ ГОЛОВОК

MANDRINI PER FRESE CON ATTACCO FILETTATO  
MANDRINS POUR FRAISER A VISSER  
螺纹连接型铣刀的铣刀杆

SHORT

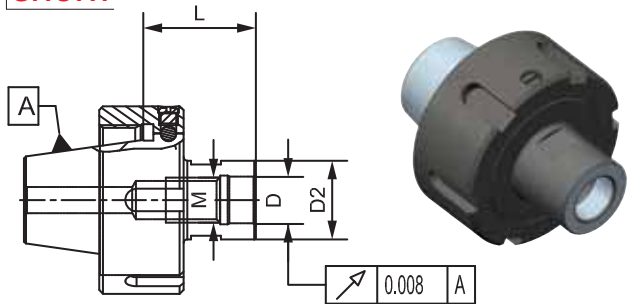

| CODE N.   | DESCRIPTION | M   | D    | D2 | L  |
|-----------|-------------|-----|------|----|----|
| 217-86705 | ER25H35M08  | M8  | 8,5  | 13 | 35 |
| 217-86706 | ER25H35M10  | M10 | 10,5 | 18 | 35 |
| 217-86707 | ER25H30M12  | M12 | 12,5 | 21 | 30 |
| 217-86708 | ER25H25M16  | M16 | 17   | 29 | 25 |
| 217-86701 | ER32H35M08  | M8  | 8,5  | 13 | 35 |
| 217-86702 | ER32H35M10  | M10 | 10,5 | 18 | 35 |
| 217-86703 | ER32H30M12  | M12 | 12,5 | 21 | 30 |
| 217-86704 | ER32H25M16  | M16 | 17   | 29 | 25 |

END MILL HOLDERS WELDON

ZYLINDERSCHAFTAUFNAHME WELDON  
CONOS PORTAHERRAMIENTAS WELDON  
ОПРАВКИ С КРЕПЛЕНИЕМ WELDON

MANDRINI PORTAFRESE TIPO WELDON  
MANDRINS POUR OUTILS TYPE WELDON  
威尔登式端铣夹具

SHORT

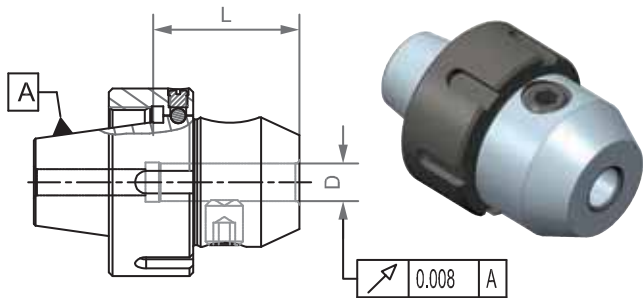

| CODE N.   | DESCRIPTION | D  | L  |
|-----------|-------------|----|----|
| 213-16707 | ER25H35WE06 | 6  | 35 |
| 213-16708 | ER25H35WE08 | 8  | 35 |
| 213-16709 | ER25H39WE10 | 10 | 39 |
| 213-16710 | ER25H43WE12 | 12 | 43 |
| 213-16701 | ER32H35WE06 | 6  | 35 |
| 213-16702 | ER32H35WE08 | 8  | 35 |
| 213-16703 | ER32H39WE10 | 10 | 39 |
| 213-16704 | ER32H43WE12 | 12 | 43 |
| 213-16705 | ER32H43WE14 | 14 | 43 |
| 213-16706 | ER32H45WE16 | 16 | 45 |

FACE MILL HOLDERS-TENONS DRIVE

AUFSTECKFRÄSDORNE FÜR FRÄSER MIT QUERNUT  
CONOS PORTAFRESAS CON REFRIGERACION INTERNA  
ОПРАВКИ ДЛЯ НАСАДНЫХ ФРЕЗ С УВЕЛИЧЕННЫМ ДИАМЕТРОМ КОРПУСА

MANDRINI PORTAFRESE A TRASCINAMENTO FISSO  
MANDRINS PORTE-FRAISE-ENTRAINEMENT PAR TENONS  
平面铣刀柄 - 凸榫驱动带有更大的法兰直径

SHORT

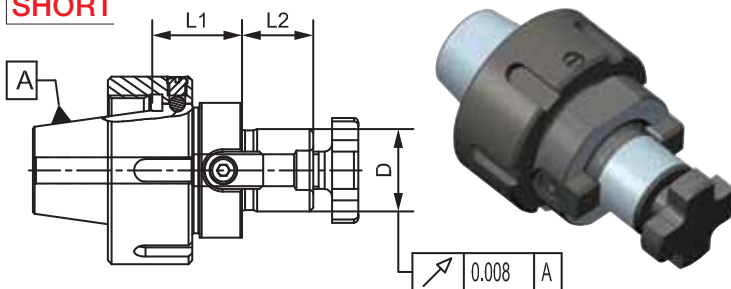

| CODE N.   | DESCRIPTION | D  | L1 | L2 |
|-----------|-------------|----|----|----|
| 216-76704 | ER25H22D16  | 16 | 22 | 17 |
| 216-76705 | ER25H24D22  | 22 | 24 | 19 |
| 216-76701 | ER32H22D16  | 16 | 22 | 17 |
| 216-76702 | ER32H24D22  | 22 | 24 | 19 |
| 216-76703 | ER32H26D27  | 27 | 26 | 21 |

ER COLLET CHUCK

SPANNZANGENFUTTER ER TYP  
CONOS PORTAPINZAS TIPO ER  
ЦАНГОВЫЕ ПАТРОНЫ ER

MANDRINI PORTAPINZA TIPO ER  
MANDRINS A PINCES TYPE ER  
ER 弹簧夹头

SHORT

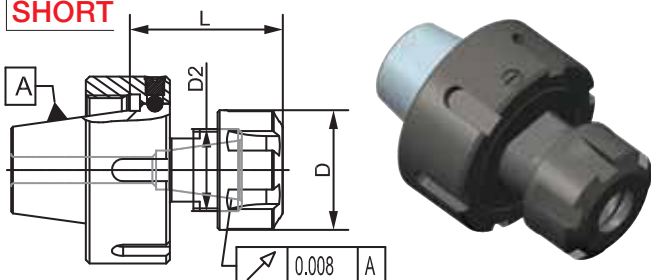

| CODE N.   | DESCRIPTION | ER | D  | D2 | L  |
|-----------|-------------|----|----|----|----|
| 214-36701 | ER25H41ER16 | 16 | 32 | 22 | 41 |
| 214-36702 | ER25H43ER20 | 20 | 35 | 25 | 43 |
| 214-36703 | ER25H45ER25 | 25 | 42 | 32 | 45 |
| 214-36704 | ER32H41ER16 | 16 | 32 | 22 | 41 |
| 214-36705 | ER32H43ER20 | 20 | 35 | 25 | 43 |
| 214-36706 | ER32H45ER25 | 25 | 42 | 32 | 45 |
| 214-36707 | ER32H48ER32 | 32 | 50 | 40 | 48 |

MILLING CUTTER ARBORS FOR SCREW-ON TYPE MILLING CUTTERS

SPANFUTTER FÜR EINSCHRAUBFRÄSER MANDRINI PER FRESE CON ATTACCO FILETTATO  
 CONOS PORTAFRESAS CON EXTREMO ROSCADO MANDRINS POUR FRAISER A VISSER  
 ОПРАВКИ ДЛЯ ФРЕЗЕРНЫХ ГОЛОВОК 螺纹连接型铣刀的铣刀杆

LONG

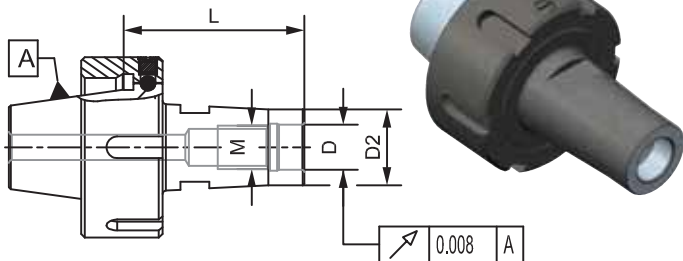

| CODE N.   | DESCRIPTION | M   | D    | D2 | L  |
|-----------|-------------|-----|------|----|----|
| 217-86709 | ER25H55M08  | M8  | 8,5  | 13 | 55 |
| 217-86710 | ER25H55M10  | M10 | 10,5 | 18 | 55 |
| 217-86711 | ER25H50M12  | M12 | 12,5 | 21 | 50 |
| 217-86712 | ER25H45M16  | M16 | 17   | 29 | 45 |
| 217-86713 | ER32H55M08  | M8  | 8,5  | 13 | 55 |
| 217-86714 | ER32H55M10  | M10 | 10,5 | 18 | 55 |
| 217-86715 | ER32H50M12  | M12 | 12,5 | 21 | 50 |
| 217-86716 | ER32H45M16  | M16 | 17   | 29 | 45 |

END MILL HOLDERS WELDON

ZYLINDERSCHAFTAUFNAHME WELDON MANDRINI PORTAFRESE TIPO WELDON  
 CONOS PORTAHERRAMIENTAS WELDON MANDRINS POUR OUTILS TYPE WELDON  
 ОПРАВКИ С КРЕПЛЕНИЕМ WELDON 威尔登式端铣夹具

LONG

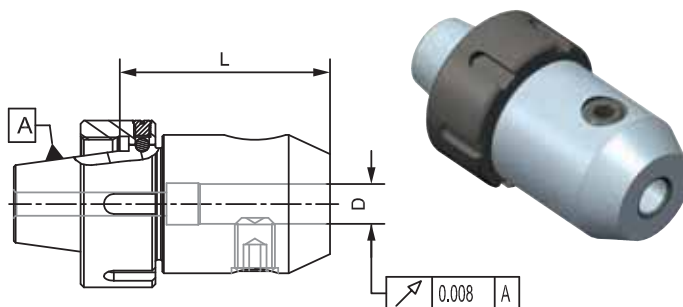

| CODE N.   | DESCRIPTION | D  | L  |
|-----------|-------------|----|----|
| 213-16711 | ER25H55WE06 | 6  | 55 |
| 213-16712 | ER25H55WE08 | 8  | 55 |
| 213-16713 | ER25H59WE10 | 10 | 59 |
| 213-16714 | ER25H63WE12 | 12 | 63 |
| 213-16715 | ER32H55WE06 | 6  | 55 |
| 213-16716 | ER32H55WE08 | 8  | 55 |
| 213-16717 | ER32H59WE10 | 10 | 59 |
| 213-16718 | ER32H63WE12 | 12 | 63 |
| 213-16719 | ER32H63WE14 | 14 | 63 |
| 213-16720 | ER32H65WE16 | 16 | 65 |

FACE MILL HOLDERS-TENONS DRIVE

AUFSTECKFRÄSDORNE FÜR FRÄSER MIT QUERNUT MANDRINI PORTAFRESE A TRASCINAMENTO FISSO  
 CONOS PORTAFRESAS CON REFRIGERACION INTERNA MANDRINS PORTE-FRAISE-ENTRAINEMENT PAR TENONS  
 ОПРАВКИ ДЛЯ НАСАДНЫХ ФРЕЗ С УВЕЛИЧЕННЫМ ДИАМЕТРОМ КОРПУСА 平面铣刀柄 - 凸榫驱动带有更大的法兰直径

LONG

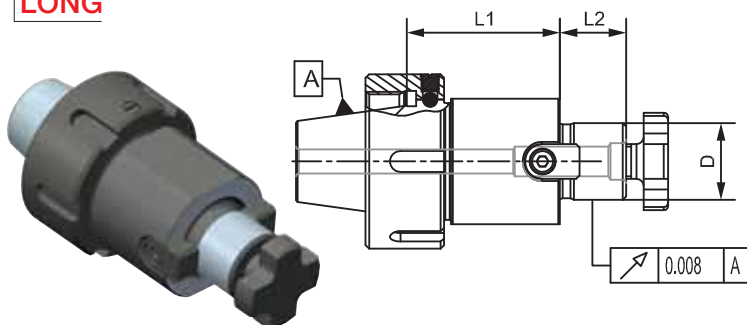

| CODE N.   | DESCRIPTION | D  | L1 | L2 |
|-----------|-------------|----|----|----|
| 216-76706 | ER25H42D16  | 16 | 42 | 17 |
| 216-76707 | ER25H44D22  | 22 | 44 | 19 |
| 216-76708 | ER32H42D16  | 16 | 42 | 17 |
| 216-76709 | ER32H44D22  | 22 | 44 | 19 |
| 216-76710 | ER32H46D27  | 27 | 46 | 21 |

BLANK TOOLHOLDER WITH SOFT SHANK

ROHLINGE MIT WEICHEM SCHAFT MANDRINI SEMILAVORATI A STELO TENERO  
 CONOS PORTAPINZAS TIPO ER BARRES D'ALEPAGE SEMI-FINIES  
 ЗАГОТОВКИ ДЛЯ ОПРАВОК НЕЗАКАЛЕННЫЕ 带软柄的切断刀柄

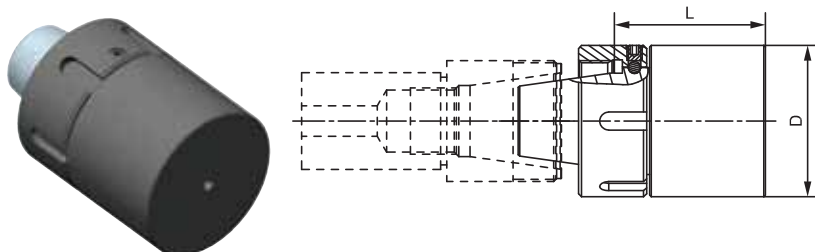

| CODE N.   | DESCRIPTION   | D  | L  |
|-----------|---------------|----|----|
| 217-46701 | ER25H70D40SML | 40 | 70 |
| 217-46702 | ER32H70D50SML | 50 | 70 |

Required for machining: Cylindrical collet chuck.  
 For example: KINTEK 214-35132 & 214-35117